



Apartment 9 Harris View Apartments, 1-2 Mona Terrace, Douglas, IM1 3LZ
Asking Price £229,500



- Top-floor apartment with panoramic views over Douglas and Onchan Bay
- Two bathrooms – a stylish en-suite plus a well-appointed family bathroom
- Two spacious double bedrooms, including a principal suite with en-suite shower room
- Designated off-road parking space, a valuable asset in this prime location
- Open-plan kitchen, dining & living area with modern fittings and abundant natural light
- Walking distance to Douglas city centre, promenade & amenities, combining coastal and urban living



Apartment 9 Harris View Apartments, 1-2 Mona Terrace, Douglas, IM1 3LZ

Perched at the very top of the development, Apartment 9, Harris View Apartments offers a unique opportunity to enjoy modern living with some of the finest views over Douglas and Onchan Bay. This beautifully presented two-bedroom, two-bathroom apartment combines convenience, comfort, and a highly desirable coastal outlook, making it an excellent choice for professionals, downsizers, or those seeking a stylish lock-up-and-leave residence.

The apartment features a spacious open-plan kitchen, dining, and living area, flooded with natural light and designed to maximise the panoramic sea and coastal views. Large windows and an elevated position create a sense of space and openness, while the well-appointed kitchen offers ample storage, integrated appliances, and a breakfast bar, ideal for both everyday use and entertaining.

There are two generous double bedrooms, including a principal suite with its own en-suite shower room. The second bedroom is equally well-proportioned and is served by a modern family bathroom, making the layout highly versatile for couples, sharers, or visiting guests.

Externally, the property benefits from a designated off-road parking space, a valuable asset in this central location. Situated within walking distance of Douglas city centre, the promenade, and local amenities, residents can enjoy the perfect blend of coastal living and urban convenience. Excellent transport links, shops, restaurants, and leisure facilities are all close by, enhancing the property's appeal as both a permanent residence and an investment opportunity.

Stylish, low-maintenance, and located in a sought-after position, Apartment 9 at Harris View offers the very best of apartment living with breathtaking sea views to match. Early viewing is strongly recommended to fully appreciate the quality of accommodation and enviable setting on offer.



Apartment 9 Harris View Apartments, 1-2 Mona Terrace, Douglas, IM1 3LZ





Apartment 9 Harris View Apartments, 1-2 Mona Terrace, Douglas, IM1 3LZ

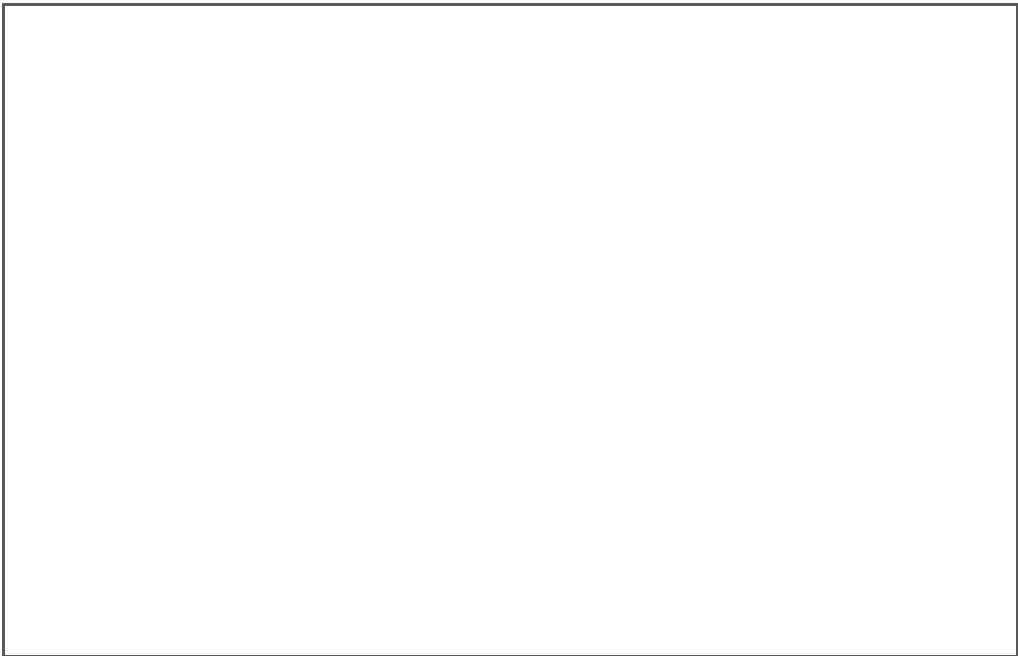
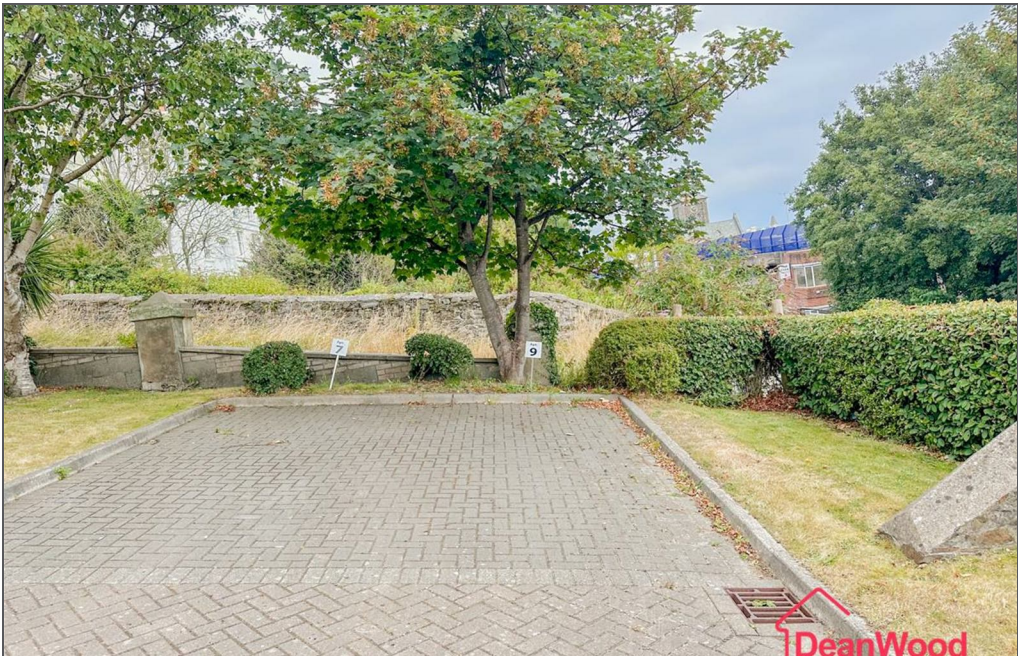

--	--	--

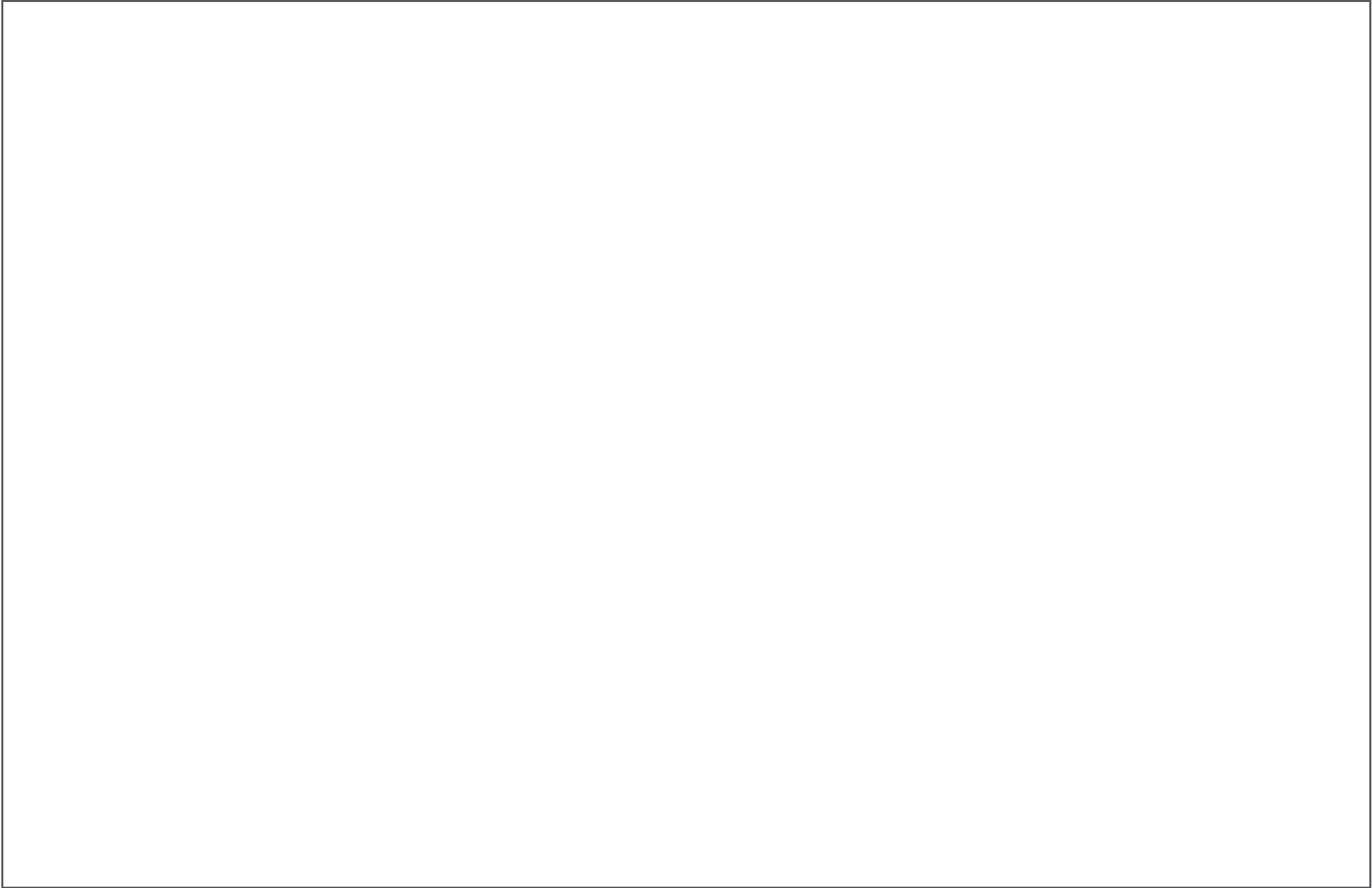

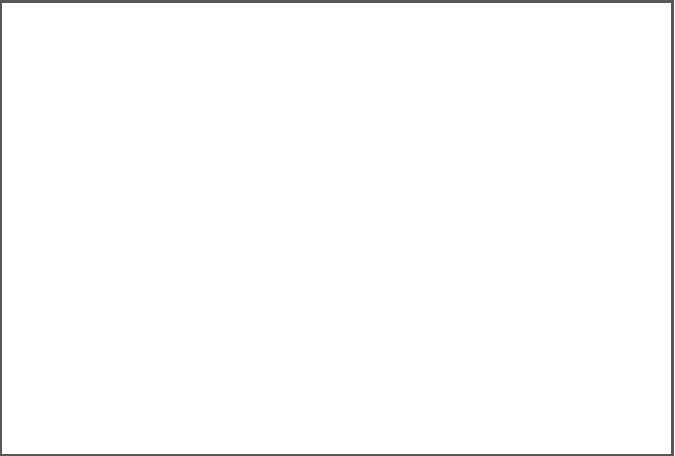
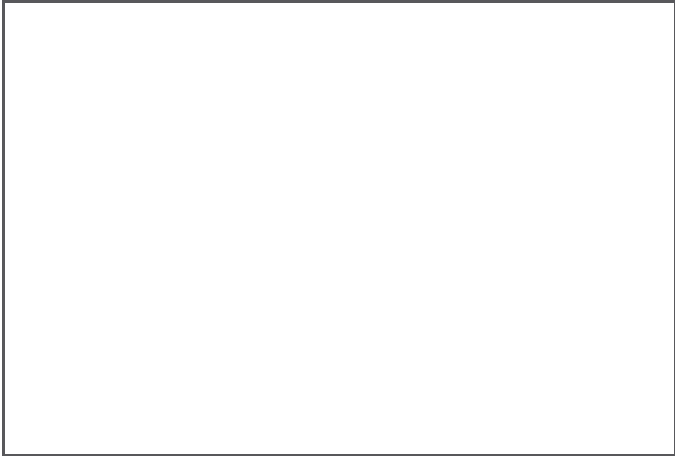

Apartment 9 Harris View Apartments, 1-2 Mona Terrace, Douglas, IM1 3LZ

GROUND FLOOR
697 sq.ft. (64.7 sq.m.) approx.

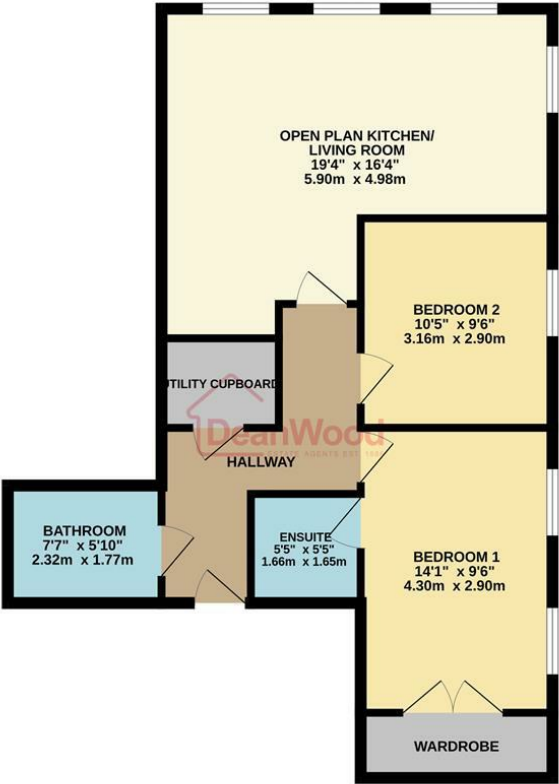

TOTAL FLOOR AREA : 697 sq.ft. (64.7 sq.m.) approx.
Not to scale-for identification purposes only
Made with Metropix (2005)



DOUGLAS
37 VICTORIA STREET
DOUGLAS
ISLE OF MAN IM1 2LF
T 01624 620606
F 01624 677363
E info@deanwood.co.im

CASTLETOWN
COMPTON HOUSE
9 CASTLE STREET CASTLETOWN
ISLE OF MAN IM9 1LF
T 01624 825995
F 01624 825996
E castletown@deanwood.co.im

RAMSEY
LEZAYRE HOUSE
87 PARLIAMENT STREET
RAMSEY ISLE OF MAN IM8 1AQ
T 01624 816111
F 01624 816588
E ramsey@deanwood.co.im

These particulars are for information purposes only. They do not constitute or form any contract nor should any statement contained herein be relied upon as a representation of fact. Neither the vendor nor DeanWood Agencies Limited ('the firm'), nor any officer or employee of the firm accept liability or responsibility for any statement contained herein. The vendor does not by these particulars, nor does the firm, nor does any officer or any employee of the firm have any authority to make or give any representation or warranty whatsoever as regards the property or otherwise. It is the sole responsibility of any person interested in the property described in these particulars to make all proper enquiries and searches to verify the description of the property and all other particulars herein.

FOR MORE PROPERTIES VISIT OUR WEBSITE @ **deanwood.im**